

PART NUMBER	REV	FIRST USED	TERMINATOR	FEED TYPE	DESCRIPTION
1339800-1	A		BENCH & LEADMAKER	MECH POST FEED	HD-I APPLICATOR
7-1339800-1	A		BENCH & LEADMAKER	MECH POST FEED	-1 AND SPARE PARTS
7-1339800-7	A		-	-	SPARE PARTS KIT

**CRIMP DATA** AMP TERMINAL AMP CRIMP SPECS

TERMINAL NAME: RECEPT, FASTIN-FASTON, .110 SERIES

CRIMP	SIZE	TYPE	RANGE
WIRE	2.29 [ .090 IN]	F	0.75-1.50mm <sup>2</sup> (18-14 AWG)
INSUL	3.56 [ .140 IN]	F	1.52-2.79 [ .060-.110 IN]
WIRE STRIP LENGTH			APPL INSTRUCTION
3.94-4.34 [ .155-.171 IN]			408-8323

TERMINAL	FEED
APPL SPEC 114-2065	15.62 [ .615 IN]

**TERMINALS APPLIED**

TERMINAL	REV	DESCRIPTION
1217321	-	-
-	-	-
-	-	-
-	-	-
-	-	-
-	-	-
-	-	-
-	-	-
-	-	-
-	-	-
-	-	-

WIRE SIZE mm <sup>2</sup> AWG	CRIMP HEIGHT	PIN PN AND LENGTH [IN]
14 AWG	1.68 ±0.05 [ .066 ±.002 IN]	9-354778-1 [ .2950]
1.50mm <sup>2</sup>	1.47 ±0.05 [ .058 ±.002 IN]	354779-8 [ .3030]
16 AWG	1.40 ±0.05 [ .055 ±.002 IN]	1-354779-4 [ .3060]
1.00mm <sup>2</sup>	1.30 ±0.05 [ .051 ±.002 IN]	2-354779-2 [ .3100]
18 AWG	1.22 ±0.05 [ .048 ±.002 IN]	2-354779-8 [ .3130]
0.75mm <sup>2</sup>	1.22 ±0.05 [ .048 ±.002 IN]	2-354779-8 [ .3130]
-	-	-
-	-	-
-	-	-
-	-	-
-	-	-
-	-	-
-	-	-

- △ RECOMMENDED SPARE PARTS.
- 2. GREASE RAM, CAM, CAM FOLLOWER AND FEED ROD LIGHTLY.
- 3. LUBRICATE DAILY PER THE APPLICATOR INSTRUCTION SHEET SUPPLIED WITH THE APPLICATOR.
- △ CERTAIN TERMINALS REQUIRE LUBRICATION. REFER TO THE APPLICATOR INSTRUCTION SHEET FOR MORE INFORMATION.

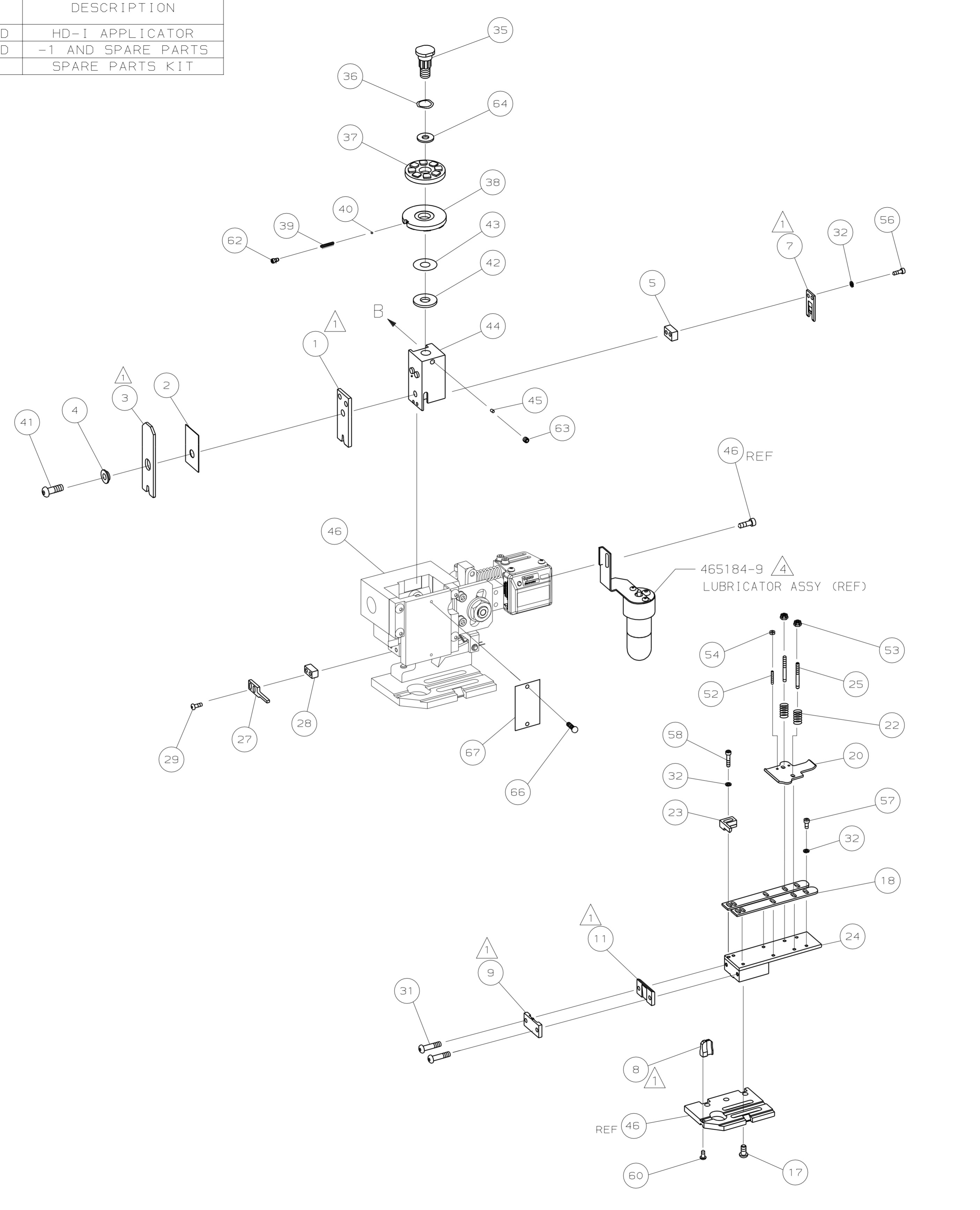
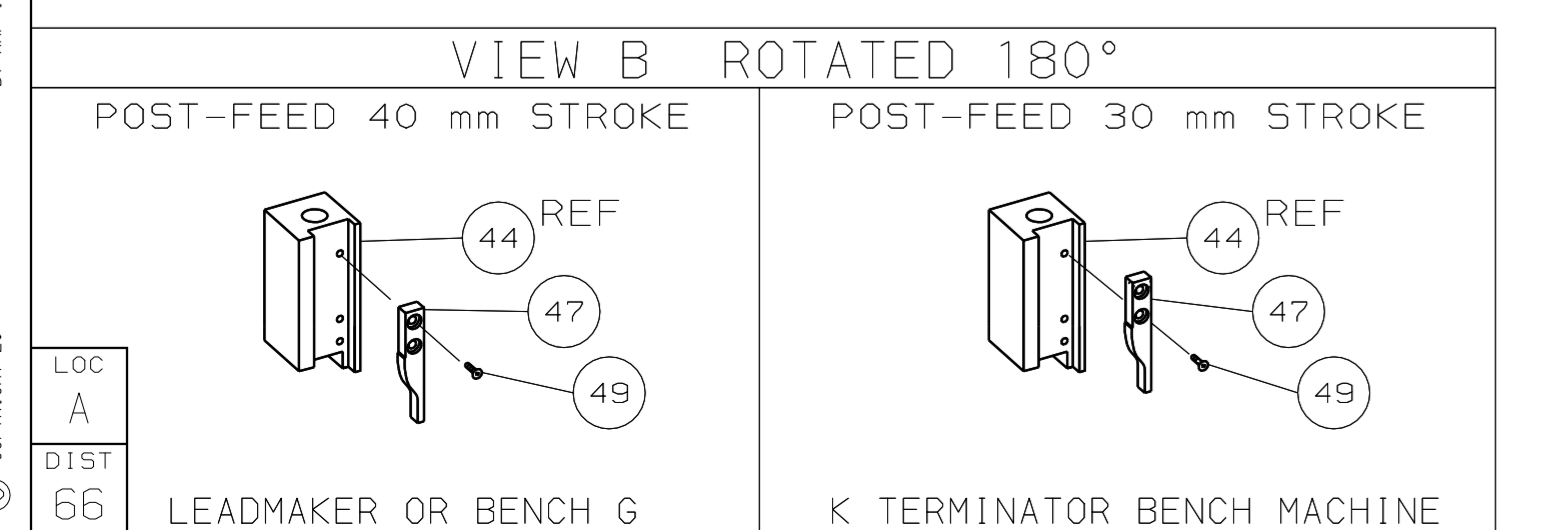

QTY	REQD	PER ASSY	PART NO	DESCRIPTION	ITEM NO	
-	1	1	1339800	PRINT, APPLICATOR LOG SHEET	73	
-	1	1	1338705-2	DOCUMENTATION PACKAGE	72	
-	-	-	-	-	70	
-	-	-	-	-	68	
-	1	1	461264-1	PLATE, IDENTIFICATION	67	
-	2	2	21017-2	SCR,DRIVE (#2X.19) ID PLATE	66	
-	-	-	-	-	65	
-	1	1	986950-1	WASHER, FLAT PRECISION	64	
-	1	1	3-18031-0	SCR,SKT SET (M6X6) RAM	63	
-	1	1	18023-9	SCR,SKT CAP (M4X6) CP DSC	62	
-	-	-	-	-	61	
-	1	1	18024-7	SCR,BHC (M4X10) ANVIL	60	
-	-	-	-	-	59	
-	2	2	1-18023-3	SCR,SHC (M4X16) HOLD DOWN	58	
-	5	5	18023-9	SCR,SHC (M4X6) STRIP GUIDE	57	
-	2	2	1-18023-1	SCR,SHC (M4X10) SLUG BLADE	56	
-	-	-	-	-	55	
-	2	2	18029-1	NUT, HEX (M3) DRAG	54	
-	2	2	986965-1	NUT, HEX SL (M4) DRAG STUD	53	
-	2	2	2-18032-2	SCR,SKT SET (M3X10) DRAG	52	
-	-	-	-	-	51	
-	-	-	-	-	50	
-	1	1	18024-3	SCR,BHC (M3X10) CAM	49	
-	-	-	-	-	48	
-	1	1	1338676-1	CAM, POST-FEED 30 & 40 mm ST	47	
-	1	1	1338662-1	APPLICATOR, BASIC (SUBASSY)	46	
-	1	1	690191-1	PLUG, NYLON	45	
-	1	1	1320998-1	RAM	44	
-	1	1	690125-1	WASHER, LAMINATED	43	
-	1	1	690124-1	WASHER, RAM	42	
-	1	1	2-18024-6	SCREW,BHC (M8X25) CRIMPER	41	
-	1	1	23241-1	BALL, STEEL	40	
-	1	1	2-22278-7	SPRING, COMPRESSION	39	
-	1	1	1320922-1	DISC, INSULATION	38	
-	1	1	354777-1	WIRE DISC, PLASTIC	37	
-	1	1	22480-5	WASHER, SPRING	36	
-	1	1	690212-1	POST, RAM	35	
-	-	-	-	-	34	
-	-	-	-	-	33	
-	9	9	18025-2	WASHER, LOCK (M4) SHEAR BL	32	
-	2	2	1-18024-0	SCR,BHC (M4X20) SHEAR PL	31	
-	-	-	-	-	30	
-	2	2	18024-8	SCR,BHC (M4X12) STRIPPER	29	
-	1	1	3-690451-2	SPACER, STRIPPER	28	
-	1	1	240639-1	STRIPPER	27	
-	-	-	-	-	26	
-	2	2	1320906-1	DRAG, STUD	25	
-	1	1	1320995-9	PLATE, STRIP GUIDE	24	
-	1	1	240825-4	PLATE, STRIP HOLD DOWN	23	
-	2	2	4-22281-1	SPRING, DRAG	22	
-	-	-	-	-	21	
-	1	1	1338665-1	DRAG, STOCK	20	
-	-	-	-	-	19	
-	2	2	1338663-5	GUIDE, LOWER STRIP	18	
-	4	4	1-18024-8	SCR,BHC (M6X12) STRIP GD PL	17	
-	-	-	-	-	16	
-	-	-	-	-	15	
-	-	-	-	-	14	
-	-	-	-	-	13	
-	-	-	-	-	12	
△	1	1	240833-3	PLATE, REAR SHEAR	11	
-	-	-	-	-	10	
△	1	1	4-690482-7	PLATE, FRONT SHEAR	9	
△	1	2	1	5-1333217-3	ANVIL	8
△	1	1	690474-5	BLADE, SLUG	7	
-	-	-	-	-	6	
-	1	1	240641-1	SPACER, SLUG BLADE	5	
-	1	1	238009-4	SPACER, BLOCK CRIMPER	4	
△	1	2	1	3-683453-1	CRIMPER, INSULATION	3
-	1	1	455888-4	SPACER, CRIMPER	2	
△	1	2	1	4-456406-1	CRIMPER, WIRE	1
-	-	-	-	-	-	
-	-	-	-	-	-	
-	-	-	-	-	-	

REVISION OF EACH ASSY NO (WHEN BLANK, USE DWG REVISION)

QTY REQD PER ASSY	PARTS LIST	MATL	HT TR	FIN
-	-	-	-	-

DR 21FEB06 APP 21FEB06  
L.L.OFTHOUSE F.BACKHURST  
CHK - REL 21MAR06 L.L.OFTHOUSE

AMP Tyco Electronics  
Harrisburg, PA 17105-3808

NAME END FEED HD-I APPLICATOR MACHINE REF HD-I APPL

SCALE DWG NO 1339800 SHEET 1 OF 1 REV A

REMOVE BURRS, BREAK SHARP EDGES RO.38 MAX

CAGE CODE 00779 CUSTOMER AND ASSEMBLY DRAWING

THIS DRAWING IS A CONTROLLED DOCUMENT.

LAYOUT L1339800 SET UP GAGE 458638-3

THIS DRAWING IS UNRELEASED. RELEASED FOR PUBLICATION BY AMP INCORPORATED. ALL RIGHTS RESERVED. LOC A DISTR 66 AMP 1756 REV 3-92